

Top View

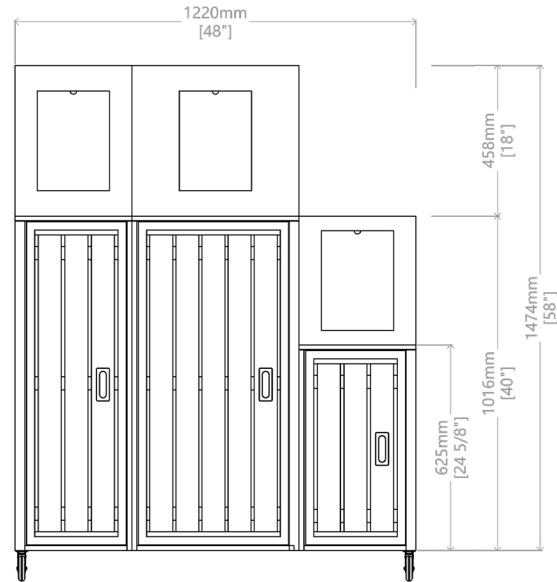

Front View

Length: 48" / 1220 mm Width: 24" / 610 mm Height: 58" / 1474 mm Weight: 330 lbs. / 150 kg

Materials:

HDPE Recycled Plastic Lumber framed with Galvanized Steel.

Finish:

Steel(metal with powder coated finish is also available),
Weather resistant, fire resistant, and resist fading by UV over time.

Installation:

No assembly required.

Options:

- Recycled Plastic Lumber options Custom label
- Wood-Plastic Composite options Additional bin
- Push flap Powdercoat color



Proprietary and confidential

All the information contained in this drawing is the property of Canaan Inc. Reproduction of the drawing in whole or in part is prohibited without the written consent of Canaan Inc. Copyright © 2016 Canaan Inc. All rights reserved.

Unless otherwise specified

All measurements are in mm; all measurements are also preliminary and may vary from final plans. We reserve the right to improve, alter or discontinue specifications without notice.

TF: 1-877-305-6638
Fax: 1-866-806-2355
Email: info@canaansf.com
www.canaansitefurnishings.com